

## Detached Villa for sale in Benahavís, Benahavís

**2,350,000 €**

Reference: R4678027 Bedrooms: 5 Bathrooms: 6 Plot Size: 2,775m<sup>2</sup> Build Size: 633m<sup>2</sup> Terrace: 233m<sup>2</sup>

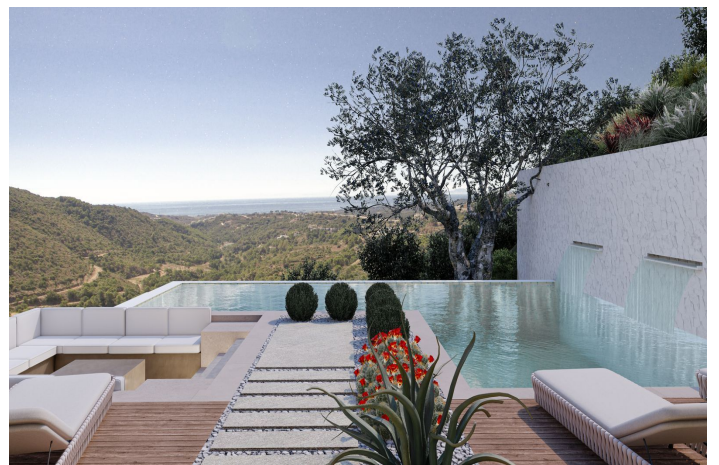

## Costa del Sol, Benahavís

Presenting a contemporary Turnkey Signature Villa designed across two angled levels. A grand XXL window feature graces the spacious hall, creating a comfortable layout that separates sleeping quarters from the main living and entertainment spaces. Accessed from the upper level, the modern home boasts a sleek driveway with wooden accents leading to a covered parking area for 2 cars.

The top-floor master suite includes a dressing room and spacious bathroom, complemented by a private terrace offering relaxing views of the surrounding nature. Just below, in the same wing, you'll find 4 ample ensuite bedrooms, each with a dressing area and sliding doors to the garden. Further on the lower level, the southwest-facing section of the villa is thoughtfully designed to benefit from the natural sunlight. An open-plan kitchen, dining, and living area layout, extends to outdoor spaces perfect for dining and lounging, around a tempting swimming pool. A special sunken lounge area with a fire pit adds a touch of enchantment to starlit evenings. Nestled in the prestigious MonteMayor enclave within the renowned municipality of Benahavís, this gated community boasts 24-hour surveillance security amidst a stunning natural setting. Located between Marbella and Estepona, it's a short drive from coastal beaches, amenities, leisure spots, shopping areas, and some of the finest golf courses.

- Build on 2 Levels
- 5 Bedrooms En Suite
- Open Plan Living area
- Fully Fitted Kitchen and Bathrooms
- Covered Parking for 2 Cars
- Gated community w/ 24 hr Security
- Turnkey Delivery, with highest quality standards and maximal structural guarantees.

## Features:

### Features

Covered Terrace  
Lift  
Near Transport  
Private Terrace  
Storage Room  
Ensuite Bathroom  
Marble Flooring  
Double Glazing  
Fitted Wardrobes  
WiFi  
Gym  
Sauna  
Utility Room  
Near Church  
Basement

### Setting

Close To Golf  
Close To Shops  
Close To Town  
Country

### Kitchen

Fully Fitted

### Parking

Private  
Covered  
More Than One

### Climate Control

Air Conditioning  
Pre Installed A/C  
Cold A/C  
Hot A/C  
U/F Heating  
U/F/H Bathrooms

### Condition

New Construction

### Garden

Private  
Landscaped  
Easy Maintenance

### Utilities

Electricity  
Drinkable Water

### Views

Sea  
Mountain  
Panoramic  
Garden  
Pool

### Pool

Private

### Security

Gated Complex  
Entry Phone

### Category

Holiday Homes  
Investment  
Golf  
Luxury  
Off Plan