

Detached Villa for sale in Sotogrande, Sotogrande

1,790,000 €

Reference: R4941130 Bedrooms: 4 Bathrooms: 5 Plot Size: 977m² Build Size: 423m² Terrace: 245m²

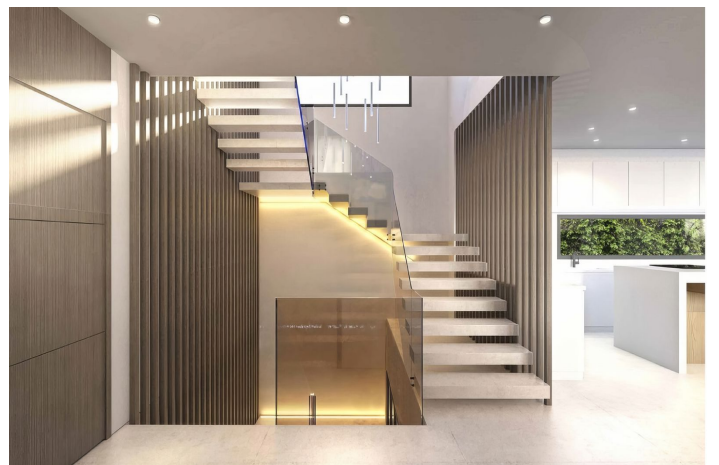

Costa de la Luz, Sotogrande

KEY READY VILLA WITH PANORAMIC SEA , GIBRALTAR AND AFRICA VIEWS-KEY READY IN ONLY 12 MONTHS!

Construction licence ready to start building immediately!

Situated in an elevated position surrounded by nature and offering breathtaking panoramic Mediterranean Sea, Gibraltar and North African Coast views and walking distance (900 meters) to a beautiful sandy beach!

Only 5 minutes drive from Sotogrande, where you can find all kinds of services such as restaurants, shopping centers, hospitals, international schools, golf courses and the port of Sotogrande.

The Real Club Valderrama is one of the best known golf clubs in the world. It is located in the resort of Sotogrande, San Roque in the Andalusia region of southern Spain, a few miles from Gibraltar, and has a single 18-hole course, along with a 9-hole par 3 course.

Great investment for those families looking for their dream home in a quiet area, surrounded by nature and just 5 minutes from all kinds of amenities.

Quality Specification (finishings medium-high quality)!

Extras Included:

- bathrooms fully installed
- fully fitted wardrobes
- aerothermal system Hisense throughout
- high-quality aluminum carpentry with thermal bridge breakage
- salt water swimming pool
- showers with glass enclosures
- mediterranean garden with zoned irrigation system
- desalination purifier
- telecommunication, wifi and alarm pre installed
- domotic system
- high quality porcelain floor indoor and outdoor

Distances:

Málaga International Airport: 45 min

Gibraltar International Airport: 15 min.

Marbella: 25 min.

Estepona: 15 min.

Sotogrande: 5 min. [Show Less](#)

Features:

Features

Covered Terrace
Lift
Private Terrace
Satellite TV
Storage Room
Ensuite Bathroom
Double Glazing
Fitted Wardrobes
Solarium
WiFi
Gym
Games Room
Utility Room
Jacuzzi
Basement
Fiber Optic

Views

Sea
Mountain
Panoramic
Garden
Pool
Urban
Forest

Pool

Private

Garden

Private

Category

Holiday Homes
Investment
Golf
Luxury
Contemporary

Orientation

South
West
South West

Setting

Close To Golf
Close To Port
Close To Sea
Close To Shops
Close To Town
Close To Schools
Close To Forest
Marina
Close To Marina

Furniture

Not Furnished

Parking

Garage
Private
More Than One

Climate Control

Air Conditioning
Cold A/C
Hot A/C
Fireplace
Central Heating

Condition

Excellent
New Construction

Kitchen

Not Fitted

Utilities

Electricity
Drinkable Water